

# Model AS Installation Guidelines

## WARNING

**DO NOT remove the looped safety pin in the extinguisher head until the pull cable is installed. The extinguisher will discharge if the pin is removed prior to connecting the actuation cable.**

### Cylinder Mounting

The extinguisher is designed to be mounted with the discharge head in the down (+ - 30 degrees) position. If specially ordered the extinguisher can be mounted horizontally. The extinguisher must be mounted in an area that will not exceed 130 degrees F for Halon 1301 or 190 degrees F for Halon 1211.

### Discharge Head

The Model AS extinguisher has a unique design that allows the cylinder to be positioned and then the top of the discharge head rotated for the pull cable hook-up. To rotate the head – loosen the set screw at the top of the discharge head – rotate it to the desired position – tighten the setscrew. The head may be a little tight when rotated – this is normal. The discharge ports do not rotate. The extinguisher comes with 1 or 2 outlets (#4 flare fitting) installed in the head. The 2<sup>nd</sup> port may be plugged. To use the 2<sup>nd</sup> port – remove the plug and install the 1/8 inch pipe thread fitting in the parts kit.

### Pull Cable Activation – see picture on back page

The safety pin or the pull cable is used to keep the spring loaded plunger in the “cocked” position. **Either of these must be in place or the extinguisher will discharge!!** The hole in which the inner cable passes through is close tolerance, so the inner cable can be a little hard to get through.

If you use the cable as supplied, sand or file the end of the inner cable to a dull point before inserting it through the head. A minimum 12 inch bend radius for the pull cable is recommended.

If you need to shorten the cable, remove the inner cable from the outer cable housing. Install the outer cable and secure it. File or sand the end of the inner cable as described above (see #1) and insert it through the outer cable housing.

The end of inner cable **MUST NOT** extend out of the head more than ¼ inch. Ensure that the cut end is free from burrs. We suggest you sand or file a smooth blunt end on the inner cable.

**When the pull cable is installed you can remove the safety pin. The safety pin MUST be removed for the extinguisher to activate.**

### Push Knob Activation – see picture on back page

If you purchased a push knob activation extinguisher, we suggest you mount the extinguisher within easy reach of the pilot. The safety pin is installed in the knob shaft that must be removed to activate the extinguisher.

### Discharge Lines

The kit is supplied with 10 ft. of ¼ inch aluminum tubing. Do not crimp the tubing when routing, use a tube bender. Slide the flare nuts and ferrules onto the lines before flaring the tube. A single flare is all that is required. A normal flaring tool can be used, the type you can get at any hardware store. The spray nozzles provide about a 120 degree spray pattern, both vertically and horizontally. Mount in the desired location to provide an unobstructed spray to the desired location. If your kit came with blue and red nozzles, use the blue nozzle for the pilot compartment and the red nozzles for the engine and or fuel tank areas. Otherwise use the red nozzles for all locations.

**For the Model AS Electric Installation consult the factory.**

#### CALIFORNIA (HEADQUARTERS)

5165-C Commercial Circle, Concord, CA 94520  
Phone: 800-400-2259 Fax: 925-405-0311  
email: info@safecraft.com

#### NORTH CAROLINA (REPAIR FACILITY)

5980 Grand National Lane, Concord, NC 28027  
Phone: 704-455-9422

NO WARRANTIES, EXPRESSED OR IMPLIED ARE MADE FOR THE SUITABILITY OF THIS PRODUCT FOR ANY PURPOSE. NO WARRANTY OR REPRESENTATION IS MADE AS TO THIS PRODUCTS ABILITY TO PROTECT THE USER FROM ANY INJURY OR DEATH. THE END USER MUST DETERMINE THE SUITABILITY OF THIS PRODUCT FOR THEIR APPLICATION.



Model AS3



Model AS5 Electric



Model AS5

**SAFECRAFT**  
SAFETY EQUIPMENT

Please Visit:

[www.safecraft.com](http://www.safecraft.com)  
to learn more about our  
complete line of  
extinguisher systems

# Model AS

## Installation Guidelines

Model LT shown on this page. The Model AS is the same system design, with minor changes to reduce weight. Pull Cable or Push Knob operation is the same for Model AS and LT.

### Model AS – Pull Cable

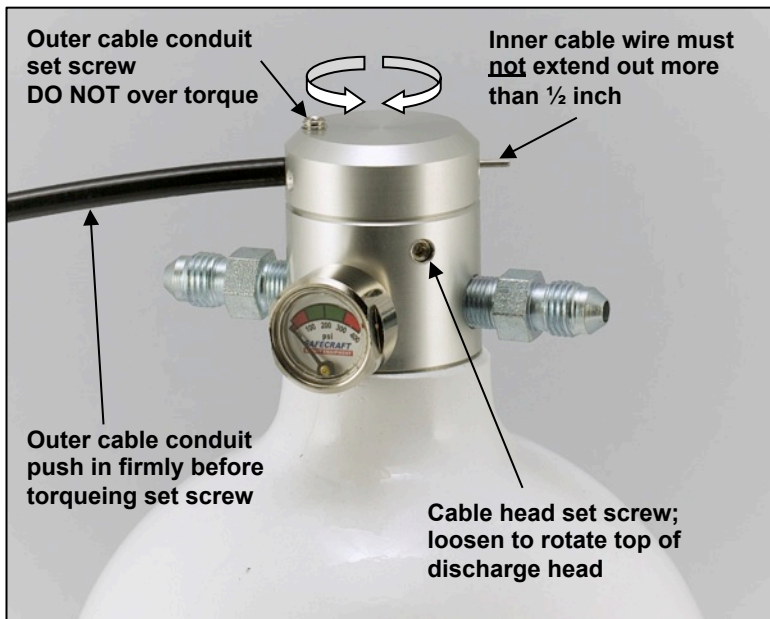

### Model AS – Push Knob

